

Customer Information Sheet

IF IN DOUBT - ASK



NOT TO SCALE

THIRD ANGLE PROJECTION

ALL DIMENSIONS IN mm

TABLE 1: CONFIGURATIONS & BILL OF MATERIALS

ORDER CODE CONFIGURATIONS																BOM ITEM No.							
KA1-XXXXX-X-XXXXX-XXXX																1	2	3	4	5			
																CONNECTOR 1 (SEE ORDER CODE FOR TOTAL No. OF CONTACTS)	CONNECTOR 1 CONTACT (SEE ORDER CODE FOR TOTAL No. OF CONTACTS)	WIRE TYPE	CONNECTOR 2 (SEE ORDER CODE FOR TOTAL No. OF CONTACTS)	CONNECTOR 2 CONTACT (SEE ORDER CODE FOR TOTAL No. OF CONTACTS)			
KA1	-	F	S	V	A B C D	1 2	-	2 3 4	-	XXXX	A B C	-	F	V	A	1 2	KA1-201XX98F1 KA1-201XX98F2	KA1-0400005 KA1-0450005	8AWG SILICONE WIRE (SEE C049XX)	KA1-201XX98F1 KA1-201XX98F2	KA1-0400005 KA1-0450005		
				H		1 2								H	A B	1 2				KA1-202XX98F1 KA1-202XX98F2	KA1-0500005 KA1-0550005	KA1-202XX98F1 KA1-202XX98F2	KA1-0500005 KA1-0550005
		M	V	1 3 5		M							V	A	1 3 5	KA1-301XX98M1 KA1-301XX98M3 KA1-301XX98M5	KA1-1410005 KA1-1450005	KA1-301XX98M1 KA1-301XX98M3 KA1-301XX98M5		KA1-1410005 KA1-1450005			
																		V		1 2	KA1-201XX98F1 KA1-201XX98F2	KA1-0400005 KA1-0450005	
														F	H			A B		1 2	KA1-202XX98F1 KA1-202XX98F2	KA1-0500005 KA1-0550005	KA1-202XX98F1 KA1-202XX98F2

TABLE 1 CONT.: ACCESSORY BOM

POTTING	BACKSHELL 1	BACKSHELL 2	BRAIDING & TAPE
6	7	8	9
SEE C049XX	KA1-970XX00	KA1-970XX00	SEE C049XX
	KA1-980XX00	KA1-980XX00	
	KA1-970XX00	KA1-970XX00	
		KA1-980XX00	

- NOTES:
- CABLE ASSEMBLIES ARE BULK PACKED IN BAGS.
 - WIRING OF CONNECTORS:
CONTACT No.1 TO CONTACT No.1,
CONTACT No.2 TO CONTACT No.2, ETC.
 - FOR COMPLETE SPECIFICATION,INCLUDING WIRE TYPE AND GAUGE
SEE COMPONENT SPECIFICATIONS C052XX & C049XX (LATEST ISSUE).
 - CUSTOM LENGTH CABLE ASSEMBLIES CAN BE PRODUCED FROM
100mm TO 9999mm.
 - CONTACT EXTRACTION TOOL = ZA1-904.
 - FOR FIXING IDENTIFICATION SEE SHEETS 6 OR 7.
 - ASSEMBLIES SHOWN FOR ILLUSTRATIVE PURPOSES ONLY AND
WILL DIFFER BASED ON PART NUMBER.
 - POSSIBLE CONFIGURATIONS:
FEMALE-TO-FEMALE
MALE-TO-MALE
MALE-TO-FEMALE.

ORDER CODE:

KA1-XXXXX-X-XXXXX-XXXX

GENDER:

F = FEMALE
M = MALE

CONTACT TERMINTATION:

S = SOLDER CUP
C = CRIMP

CONTACT STYLE:

V = VERTICAL
H = HORIZONTAL (90°)

ACCESSORIES:

A= NONE
B = BACKPOTTING
C = FULLY SHIELDED
D = BACKPOTTING &
SHIELDING

FIXING TYPE:

1 = F1 / M1 2 = F2
3 = M3 5 = M5

TOTAL No OF CONTACTS:

2, 3, 4

FIXING TYPE:

1 = F1 / M1 2 = F2
3 = M3 5 = M5

CONNECTOR 2 ORIENTATION:

A = CONTACT No.1 DOWN
B = CONTACT No.1 UP

CONTACT STYLE:

V = VERTICAL
H = HORIZONTAL

GENDER:

F = FEMALE
M = MALE

WIRE COLOUR:

A = WHITE
B = BLACK
C = RED

DIM 'A' (CABLE LENGTH):

0100 = 100mm MIN

RTP	2	26.01.24	33571
NAME	ISS.	DATE	CN/CO
APPROVED:		R.PORTLOCK	
CHECKED:		A.BOXALL	
DRAWN:		M.RUDKIN	
ASSEMBLY DRG:			

HARWIN

www.harwin.com

TOLERANCES

X. = ±1mm
X.X = ±0.50mm
X.XX = ±0.20mm
X.XXX = ±0.01mm

ANGLES = ±5°
UNLESS STATED

THIS DRAWING AND ANY
INFORMATION OR DESCRIPTIVE
MATTER SET OUT HEREON ARE
CONFIDENTIAL AND COPYRIGHT
PROPERTY OF THE HARWIN GROUP
AND MUST NOT BE DISCLOSED,
LOANED, COPIED OR USED FOR
MANUFACTURING, TENDERING OR FOR
ANY OTHER PURPOSE WITHOUT THEIR
WRITTEN PERMISSION.

MATERIAL:

SEE TABLE

TITLE:

KONA SERIES
DOUBLE ENDED CABLE
ASSEMBLY

DRAWING NUMBER:

KA1-XXXXX-X-XXXXX-XXXX

SHT
5
OF
8

Customer Information Sheet

IF IN DOUBT - ASK

©

NOT TO SCALE

THIRD ANGLE PROJECTION

ALL DIMENSIONS IN mm

TABLE 1: DIMENSIONS

DIMENSION	MEASUREMENT
DIM 'B'	(TOTAL No. OF CONTACTS - 1) x 8.5
DIM 'C'	(TOTAL No. OF CONTACTS - 1) x 8.5 + 16.5
DIM 'D'	(TOTAL No. OF CONTACTS - 1) x 8.5 + 24.5

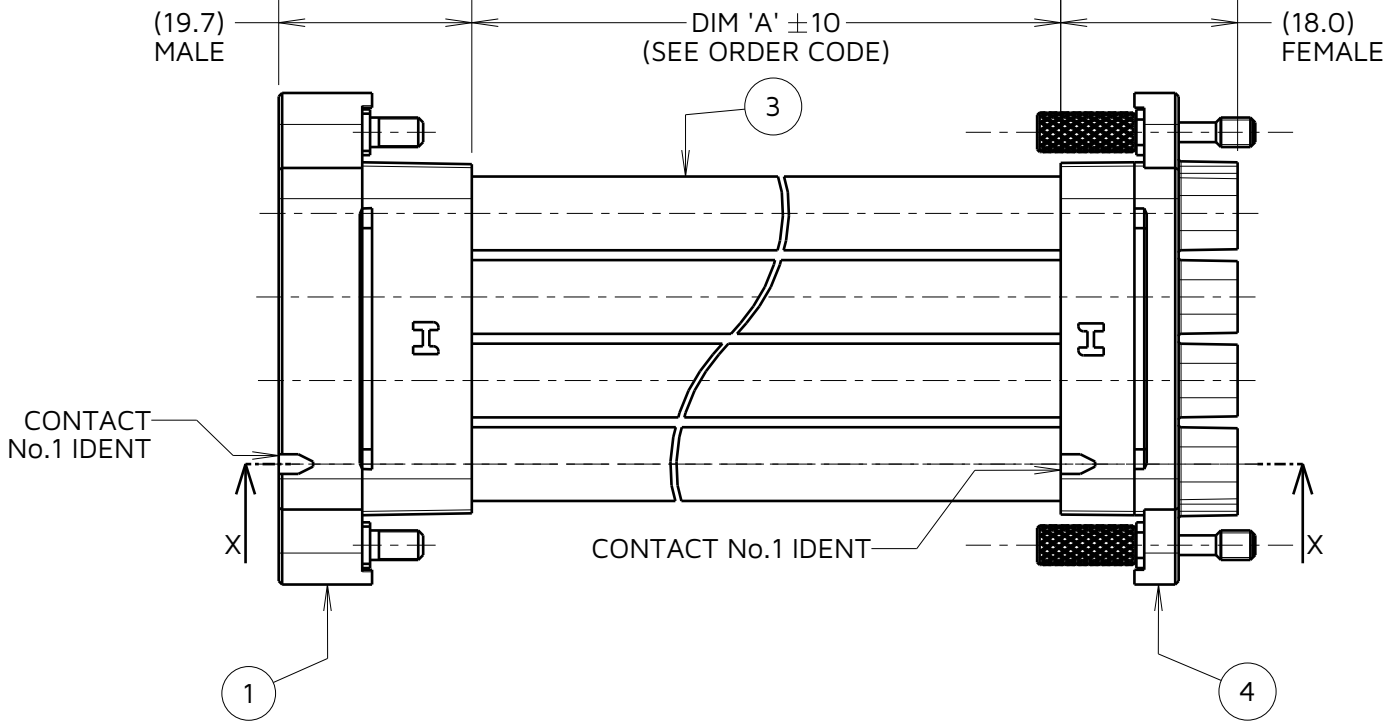
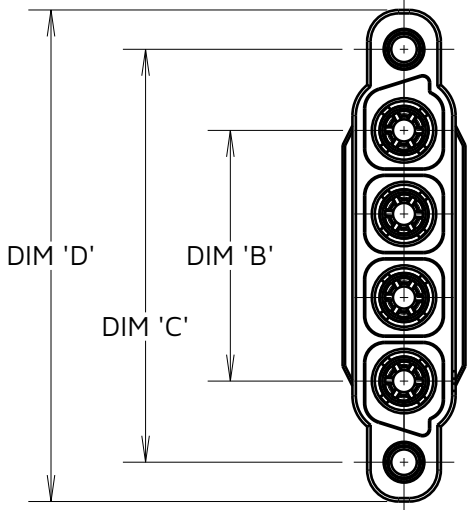

MALE CONTACTS:

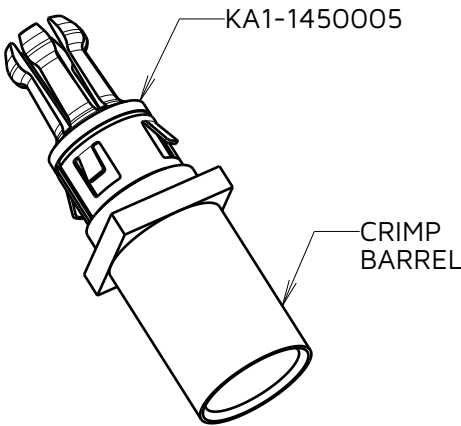
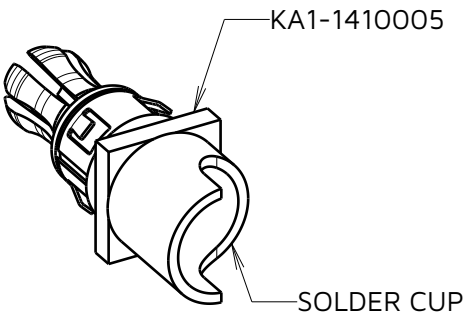

FEMALE CONTACTS:

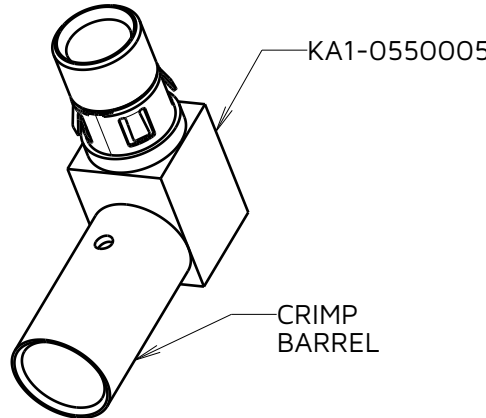
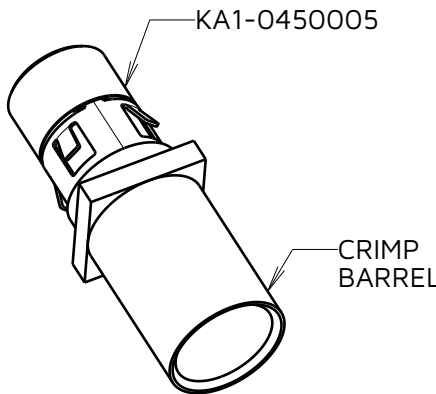
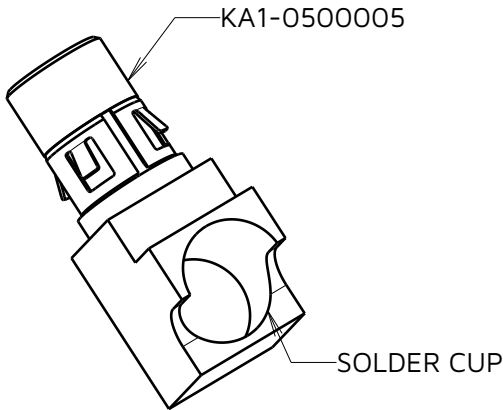
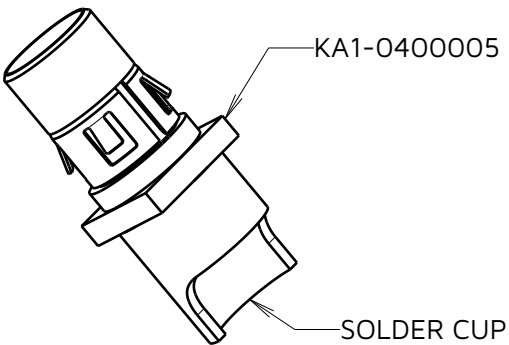

NOTES:
9. POSSIBLE CONFIGURATIONS:
FEMALE-TO-FEMALE
MALE-TO-MALE
MALE-TO-FEMALE

HARWIN

www.harwin.com

TOLERANCES

X. = ±1mm
X.X = ±0.50mm
X.XX = ±0.20mm
X.XXX = ±0.01mm
ANGLES = ±5°
UNLESS STATED

THIS DRAWING AND ANY INFORMATION OR DESCRIPTIVE MATTER SET OUT HEREON ARE CONFIDENTIAL AND COPYRIGHT PROPERTY OF THE HARWIN GROUP AND MUST NOT BE DISCLOSED, LOANED, COPIED OR USED FOR MANUFACTURING, TENDERING OR FOR ANY OTHER PURPOSE WITHOUT THEIR WRITTEN PERMISSION.

MATERIAL:

SEE SHEET 5

TITLE:

KONA SERIES
DOUBLE ENDED CABLE
ASSEMBLY

DRAWING NUMBER:

KA1-XXXXX-X-XXXXX-XXXX

SHT

6

OF

8

RTP	2	26.01.24	33571
NAME	ISS.	DATE	CN/CO
APPROVED:	R.PORTLOCK		
CHECKED:	A.BOXALL		
DRAWN:	M.RUDKIN		
ASSEMBLY DRG:			

Customer Information Sheet

IF IN DOUBT - ASK

©

NOT TO SCALE

THIRD ANGLE PROJECTION

ALL DIMENSIONS IN mm

TABLE 1: DIMENSIONS

DIMENSION	MEASUREMENT
DIM 'B'	(TOTAL No. OF CONTACTS - 1) x 8.5
DIM 'C'	(TOTAL No. OF CONTACTS - 1) x 8.5 + 16.5
DIM 'D'	(TOTAL No. OF CONTACTS - 1) x 8.5 + 24.5

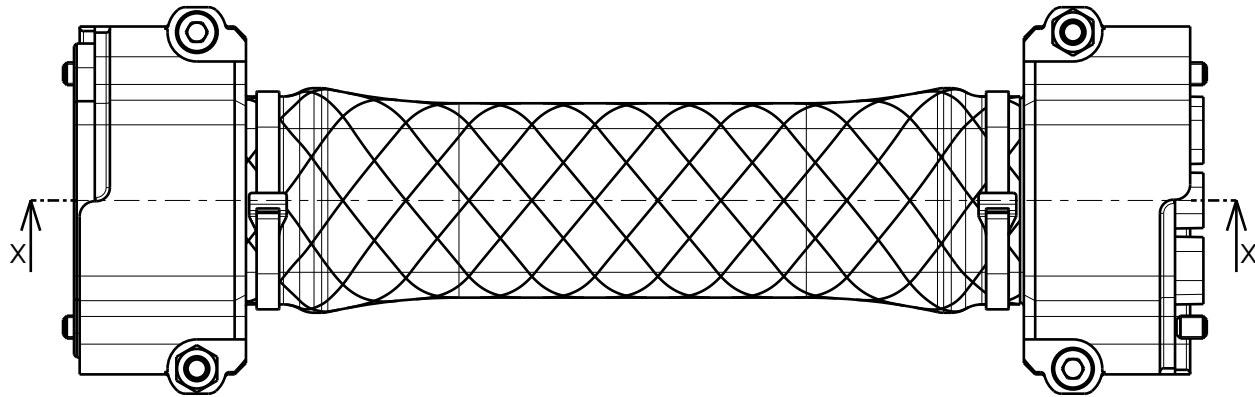
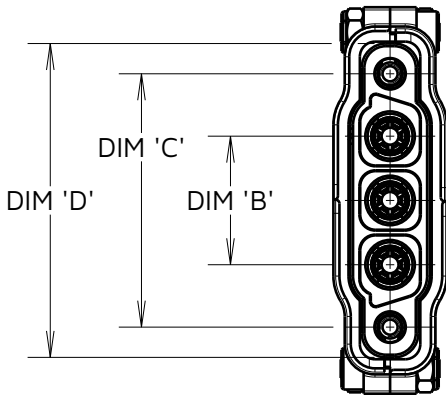

MALE CONTACTS:

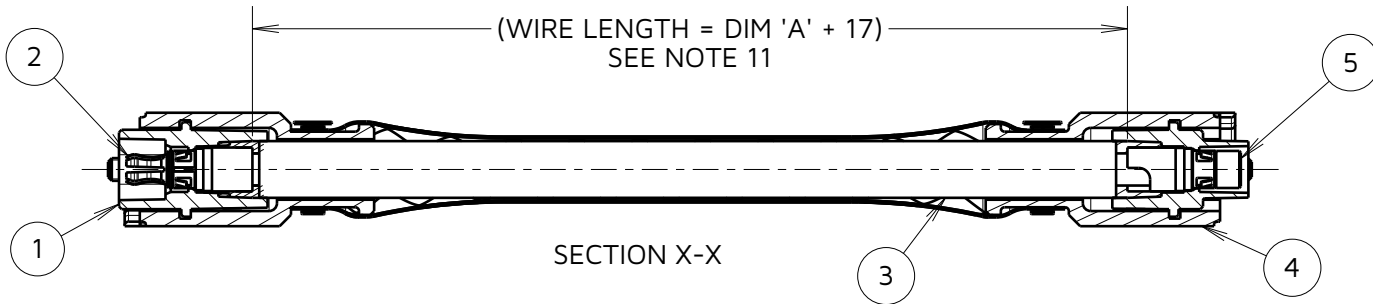
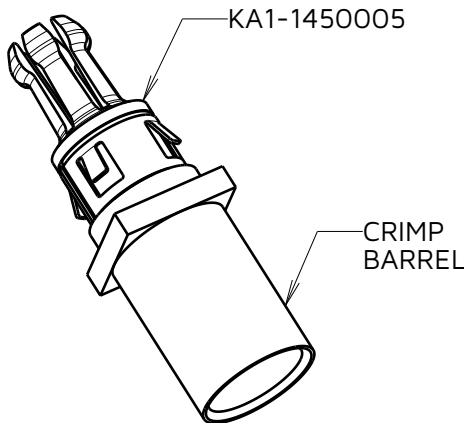
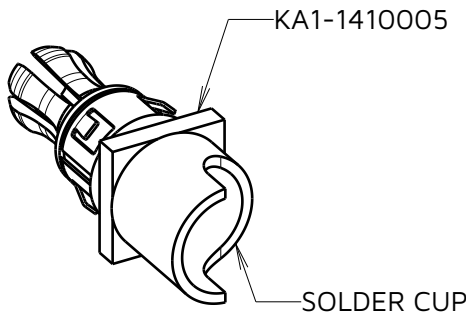

FEMALE CONTACTS:

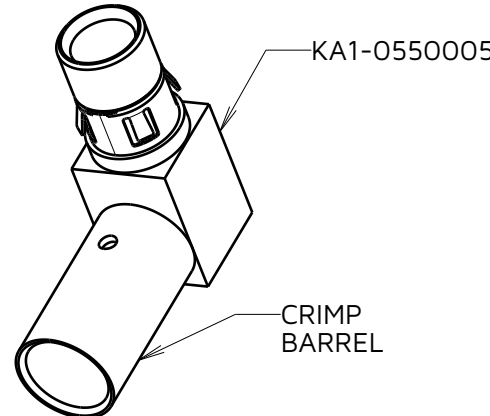
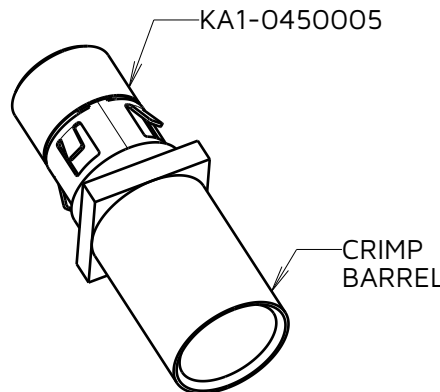
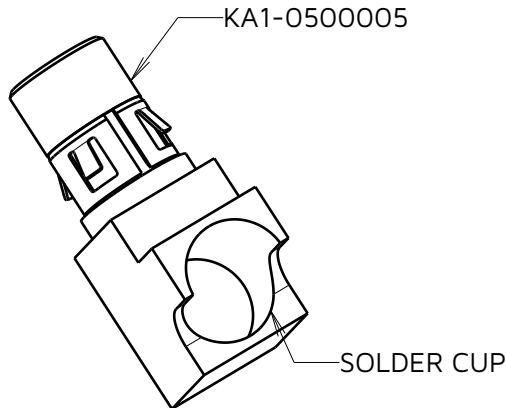
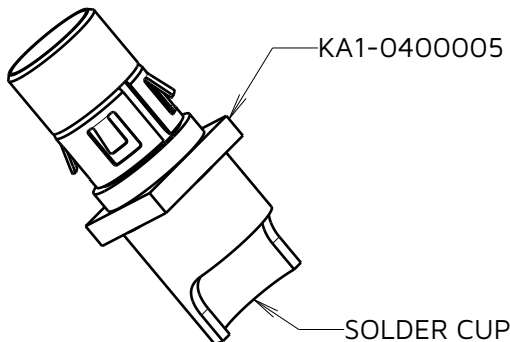

NOTES:
10. POSSIBLE CONFIGURATIONS:
FEMALE-TO-FEMALE
MALE-TO-FEMALE
MALE-TO-MALE
11. WIRE LENGTHS GIVEN FOR REFERENCE ONLY.

HARWIN

www.harwin.com

TOLERANCES
X. = ±1mm
X.X = ±0.50mm
X.XX = ±0.20mm
X.XXX = ±0.01mm
ANGLES = ±5°
UNLESS STATED

THIS DRAWING AND ANY INFORMATION OR DESCRIPTIVE MATTER SET OUT HEREON ARE CONFIDENTIAL AND COPYRIGHT PROPERTY OF THE HARWIN GROUP AND MUST NOT BE DISCLOSED, LOANED, COPIED OR USED FOR MANUFACTURING, TENDERING OR FOR ANY OTHER PURPOSE WITHOUT THEIR WRITTEN PERMISSION.

MATERIAL:

SEE SHEET 5

TITLE: KONA SERIES
DOUBLE ENDED CABLE
ASSEMBLY

DRAWING NUMBER:
KA1-XXXXX-X-XXXXX-XXXX

SHT
7
OF
8

RTP	2	26.01.24	33571
NAME	ISS.	DATE	CN/CO
APPROVED:	R.PORTLOCK		
CHECKED:	A.BOXALL		
DRAWN:	M.RUDKIN		
ASSEMBLY DRG:			

Customer Information Sheet

IF IN DOUBT - ASK

©

NOT TO SCALE

THIRD ANGLE PROJECTION

ALL DIMENSIONS IN mm

MALE FIXING TYPES

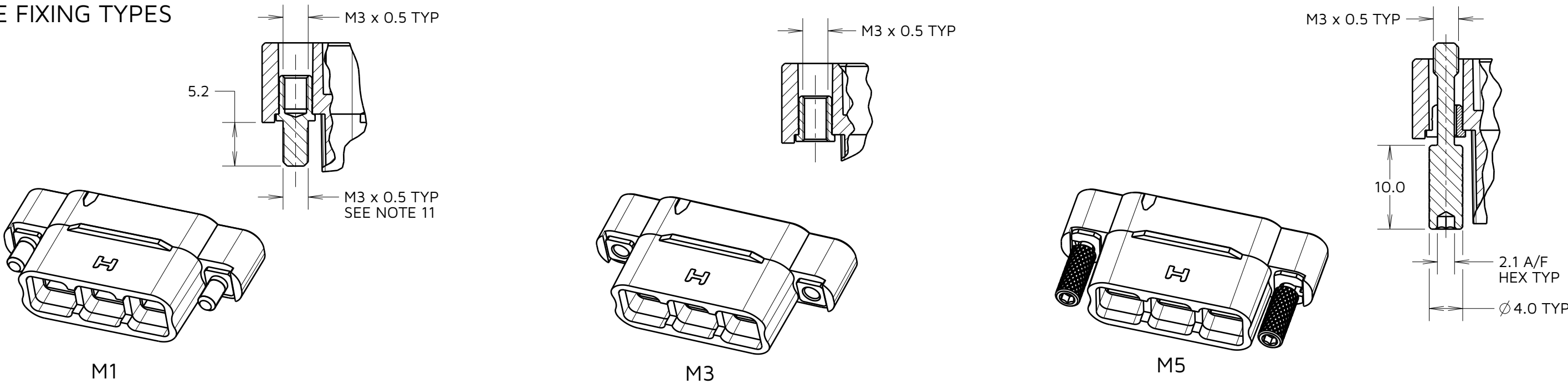

FEMALE FIXING TYPES

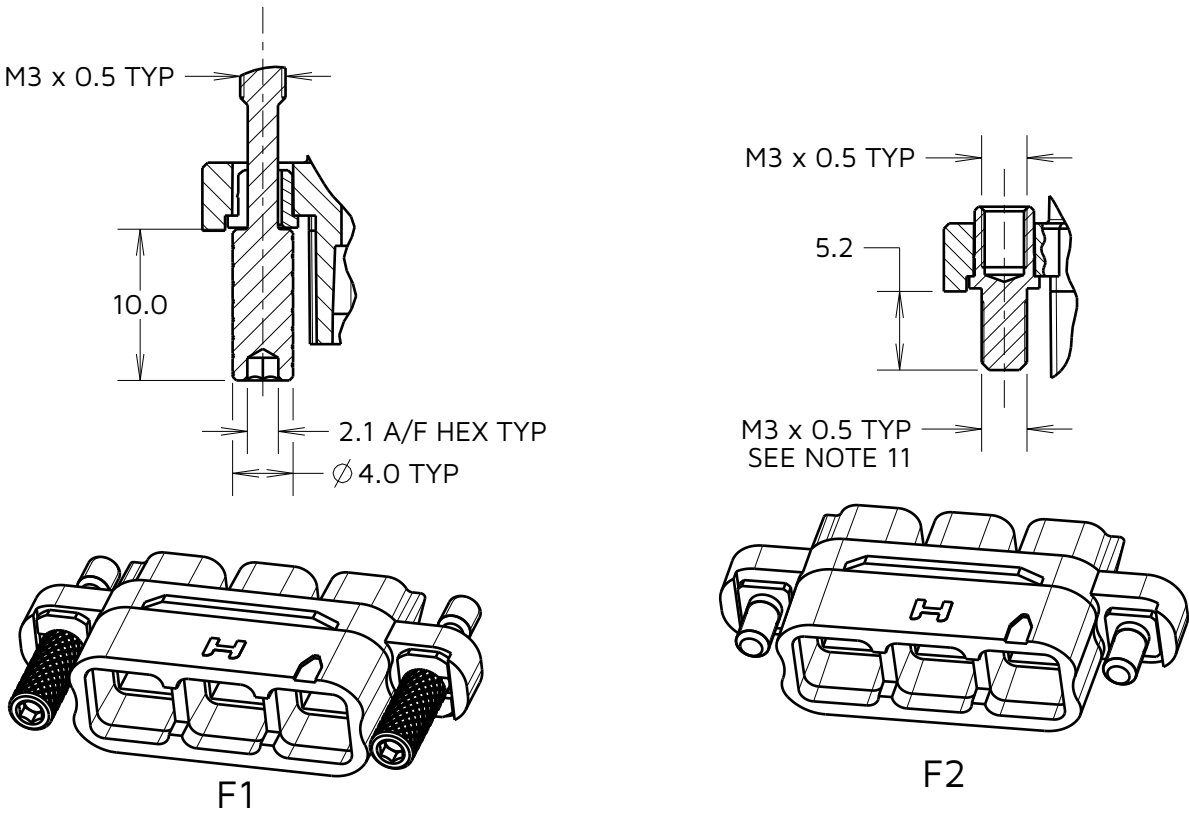

ORDER CODE:

KA1-XXXXX-X-XXXXX-XXXX

GENDER:
F = FEMALE
M = MALE

CONTACT TERMINATION:
S = SOLDER CUP
C = CRIMP

CONTACT STYLE:
V = VERTICAL
H = HORIZONTAL (90°)

ACCESSORIES:
A = NONE
B = BACKPOTTING
C = FULLY SHIELDED
D = BACKPOTTING & SHIELDING

FIXING TYPE:
1 = F1 / M1 2 = F2
3 = M3 5 = M5

TOTAL No OF CONTACTS:
2, 3, 4

DIM 'A' (CABLE LENGTH):
0100 = 100mm MIN

FIXING TYPE:
1 = F1 / M1 2 = F2
3 = M3 5 = M5

CONNECTOR 2 ORIENTATION:
A = CONTACT No.1 DOWN
B = CONTACT No.1 UP

CONTACT STYLE:
V = VERTICAL
H = HORIZONTAL

GENDER:
F = FEMALE
M = MALE

WIRE COLOUR:
A = WHITE
B = BLACK
C = RED

- NOTES:
- SEE BILL OF MATERIALS TABLE ON SHEET 5 AND ORDER CODE FOR FIXING IDENTIFICATION.
 - FOR PANEL MOUNT NUTS ORDER SEPARATELY PART NUMBER: KA1-4240000, ROUND SLOTTED NUT - BAG OF 20.

HARWIN

www.harwin.com

TOLERANCES
X. = $\pm 1\text{mm}$
X.X = $\pm 0.50\text{mm}$
X.XX = $\pm 0.20\text{mm}$
X.XXX = $\pm 0.01\text{mm}$
ANGLES = $\pm 5^\circ$
UNLESS STATED

THIS DRAWING AND ANY INFORMATION OR DESCRIPTIVE MATTER SET OUT HEREON ARE CONFIDENTIAL AND COPYRIGHT PROPERTY OF THE HARWIN GROUP AND MUST NOT BE DISCLOSED, LOANED, COPIED OR USED FOR MANUFACTURING, TENDERING OR FOR ANY OTHER PURPOSE WITHOUT THEIR WRITTEN PERMISSION.

MATERIAL:

SEE SHEET 5

TITLE: KONA SERIES
DOUBLE ENDED CABLE
ASSEMBLY

DRAWING NUMBER:
KA1-XXXXX-X-XXXXX-XXXX

SHT
8
OF
8

RTP	2	26.01.24	33571
NAME	ISS.	DATE	CN/CO
APPROVED:		R.PORTLOCK	
CHECKED:		A.BOXALL	
DRAWN:		M.RUDKIN	
ASSEMBLY DRG:			