

Customer Information Sheet

IF IN DOUBT - ASK



NOT TO SCALE

THIRD ANGLE PROJECTION

ALL DIMENSIONS IN mm

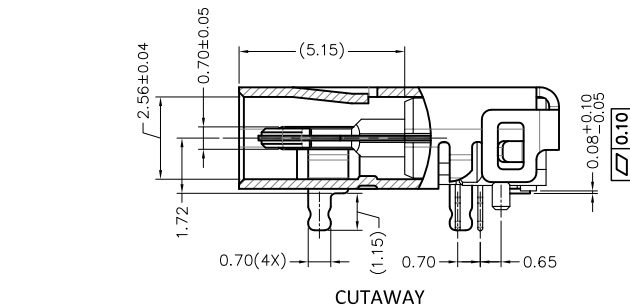
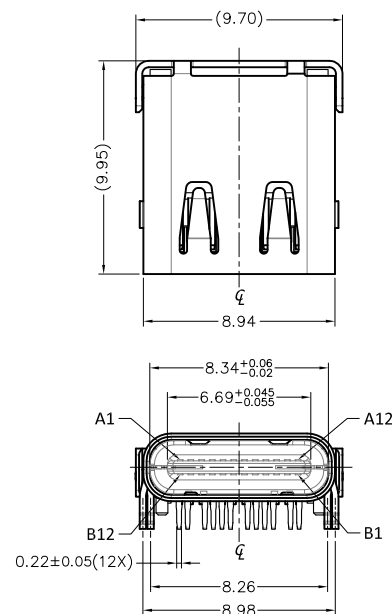

CUTAWAY

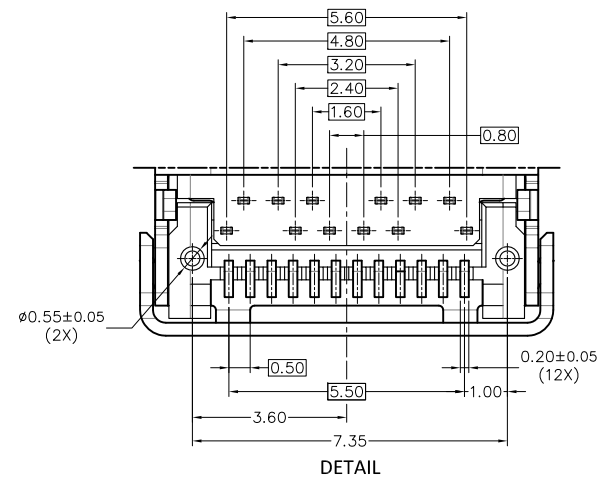

DETAIL

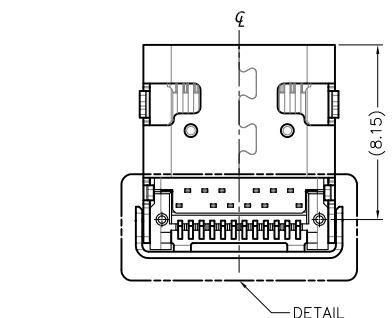
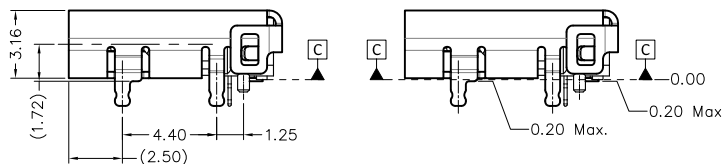

PIN ASSIGNMENTS

PIN	SIGNAL NAME	PIN	SIGNAL NAME
A1	GND	B12	GND
A2	TX1+	B11	RX1+
A3	TX1-	B10	RX1-
A4	VBUS	B9	VBUS
A5	CC1	B8	SBU2
A6	D+	B7	D-
A7	D-	B6	D+
A8	SBU1	B5	CC2
A9	VBUS	B4	VBUS
A10	RX2-	B3	TX2-
A11	RX2+	B2	TX2+
A12	GND	B1	GND

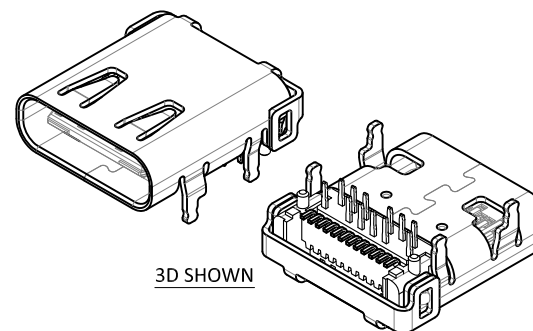

3D SHOWN

UNE	1	12JUN25	--
NAME	ISS.	DATE	CN/CO
APPROVED: WALKER / MEIZY			
CHECKED: THIRI			
DRAWN: UNE			

HARWIN

www.harwin.com

TOLERANCES

X. = ±1mm
 X.X = ±0.50mm
 X.XX = ±0.20mm
 X.XXX = ±0.01mm
 ANGLES = ±5°
 UNLESS STATED

THIS DRAWING AND ANY INFORMATION OR DESCRIPTIVE MATTER SET OUT HEREON ARE CONFIDENTIAL AND COPYRIGHT PROPERTY OF THE HARWIN GROUP AND MUST NOT BE DISCLOSED, LOANED, COPIED OR USED FOR MANUFACTURING, TENDERING OR FOR ANY OTHER PURPOSE WITHOUT THEIR WRITTEN PERMISSION.

MATERIAL & FINISH:

SEE ABOVE

TITLE:

USB 4.0 Type-C Receptacle
 Top Mount Hybrid Solder

DRAWING NUMBER:

MMUSBC-4024AF-SMHS-XXX

SHT
 1
 OF
 3

Customer Information Sheet

IF IN DOUBT - ASK



NOT TO SCALE

THIRD ANGLE PROJECTION

ALL DIMENSIONS IN mm

NOTES:

1. MATERIAL

- 1.1 HOUSING: LCP, HIGH-TEMP, UL94V-0 BLACK
- 1.2 TERMINAL: COPPER ALLOY, T=0.15MM
- 1.3 MID-PLATE: STAINLESS STEEL, T=0.15MM
- 1.4 SHELL: STAINLESS STEEL, T=0.30MM

2. PLATING

- 2.1 TERMINAL: Au ON CONTACT AREA (SEE ORDER CODE)
Sn 100 μ " MIN. ON SOLDER AREA
Ni 80 μ " MIN. UNDERPLATED OVERALL
- 2.2 MID-PLATE: CLEANING
- 2.3 SHELL: Ni 80 μ " MIN.

3. ELECTRICAL REQUIREMENTS

- 3.1 CURRENT RATING: 5A FOR TOTAL VBUS PIN
1.25A FOR VCONN PIN
0.25A FOR OTHERS PIN
- 3.2 CURRENT VOLTAGE: 30V
- 3.3 CONTACT RESISTANCE: 40m Ω MAX. (INITIAL)
50m Ω MAX. (AFTER TEST)
- 3.4 INSULATION RESISTANCE: 100M Ω MIN.
- 3.5 WITHSTANDING VOLTAGE: 100VAC

4. MECHANICAL REQUIREMENTS

- 4.1 MATING FORCE: 5N~20N
- 4.2 UNMATING FORCE: 8N~20N (INITIAL)
6N~20N (AFTER TEST)
- 4.3 DURABILITY: 10,000 CYCLES

5. OTHERS

OPERATING TEMPERATURE: -40 $^{\circ}$ ~+85 $^{\circ}$

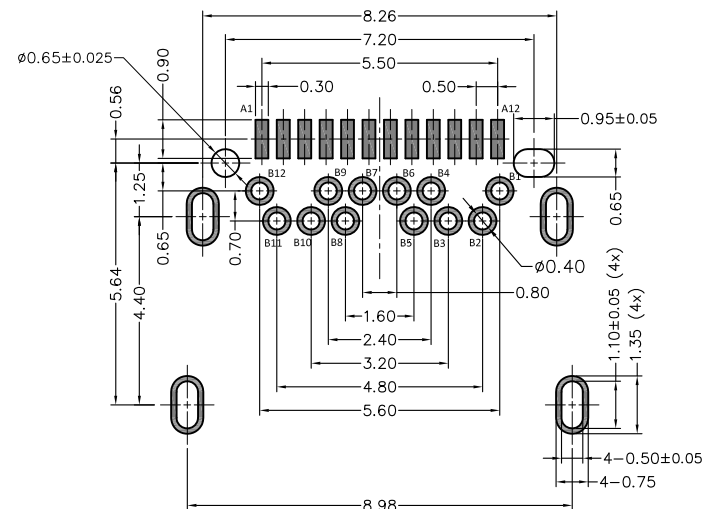

RECOMMENDED PCB LAYOUT (TOP VIEW)
THICKNESS 1.0mm DEFULT TOLERANCE ± 0.05 mm

ORDERING CODE

MMUSBC-4024AF-SMHS-XXX

CONTACT PLATING

- G01: Gold 1 μ " Min.
- G05: Gold 5 μ "
- G30: Gold 30 μ "

UNE	1	12JUN25	--
NAME	ISS.	DATE	CN/CO
APPROVED: WALKER / MEIZY			
CHECKED: THIRI			
DRAWN: UNE			

HARWIN

www.harwin.com

TOLERANCES

X. = ± 1 mm
X.X = ± 0.50 mm
X.XX = ± 0.20 mm
X.XXX = ± 0.01 mm
ANGLES = $\pm 5^{\circ}$
UNLESS STATED

THIS DRAWING AND ANY INFORMATION OR DESCRIPTIVE MATTER SET OUT HEREON ARE CONFIDENTIAL AND COPYRIGHT PROPERTY OF THE HARWIN GROUP AND MUST NOT BE DISCLOSED, LOANED, COPIED OR USED FOR MANUFACTURING, TENDERING OR FOR ANY OTHER PURPOSE WITHOUT THEIR WRITTEN PERMISSION.

MATERIAL & FINISH:

SEE ABOVE

TITLE:

USB 4.0 Type-C Receptacle
Top Mount Hybrid Solder

DRAWING NUMBER:

MMUSBC-4024AF-SMHS-XXX

SHT
2
OF
3

Customer Information Sheet

IF IN DOUBT - ASK



NOT TO SCALE

THIRD ANGLE PROJECTION

ALL DIMENSIONS IN mm

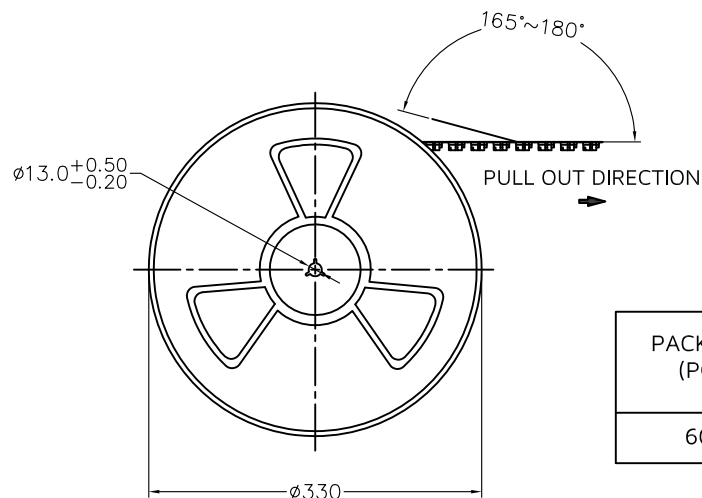
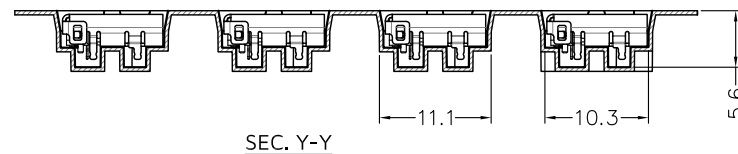
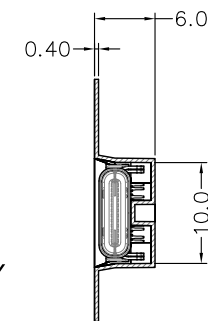
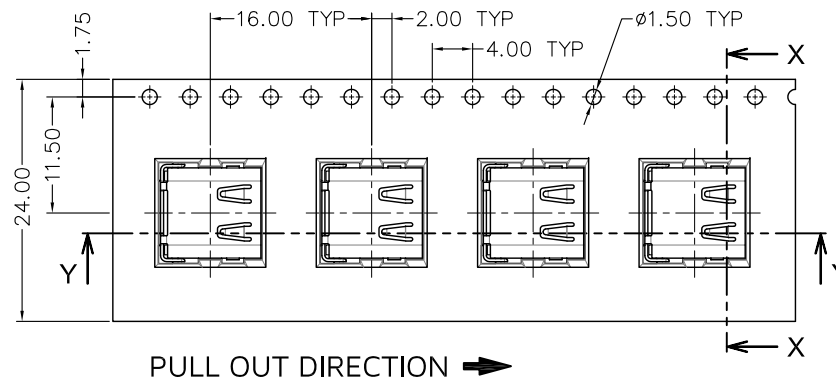
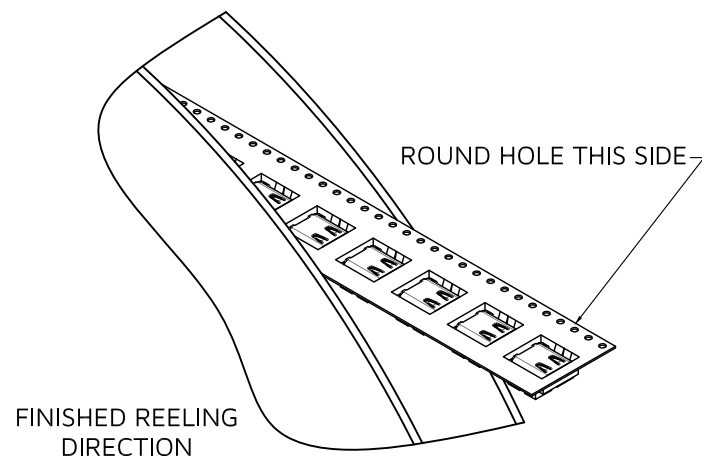

PACK QTY (PCS)
600

NOTES:
PRODUCT IS TAPE AND REELED IN GENERAL ACCORDANCE WITH EIA-481 (ELECTRONIC INDUSTRIES ASSOCIATION).

UNE	1	12JUN25	--
NAME	ISS.	DATE	CN/CO
APPROVED: WALKER / MEIZY			
CHECKED: THIRI			
DRAWN: UNE			

HARWIN

www.harwin.com

TOLERANCES

X. = ±1mm
 X.X = ±0.50mm
 X.XX = ±0.20mm
 X.XXX = ±0.01mm
 ANGLES = ±5°
 UNLESS STATED

THIS DRAWING AND ANY INFORMATION OR DESCRIPTIVE MATTER SET OUT HEREON ARE CONFIDENTIAL AND COPYRIGHT PROPERTY OF THE HARWIN GROUP AND MUST NOT BE DISCLOSED, LOANED, COPIED OR USED FOR MANUFACTURING, TENDERING OR FOR ANY OTHER PURPOSE WITHOUT THEIR WRITTEN PERMISSION.

MATERIAL & FINISH:

SEE ABOVE

TITLE:

USB 4.0 Type-C Receptacle
Top Mount Hybrid Solder

DRAWING NUMBER:

MMUSBC-4024AF-SMHS-XXX

SHT
3
OF 3